

## Rear Oxygen Sensor

FUEL INJECTION (FUEL SYSTEMS)

### 23.Rear Oxygen Sensor

#### A: REMOVAL

- 1) Disconnect the ground terminal from battery sensor. <Ref. to NT-5, BATTERY, NOTE, Note.>
- 2) Lift up the vehicle.
- 3) Remove the under cover. <Ref. to EI-21, REMOVAL, Front Under Cover.>
- 4) Disconnect the connector on the rear oxygen sensor from the engine harness.

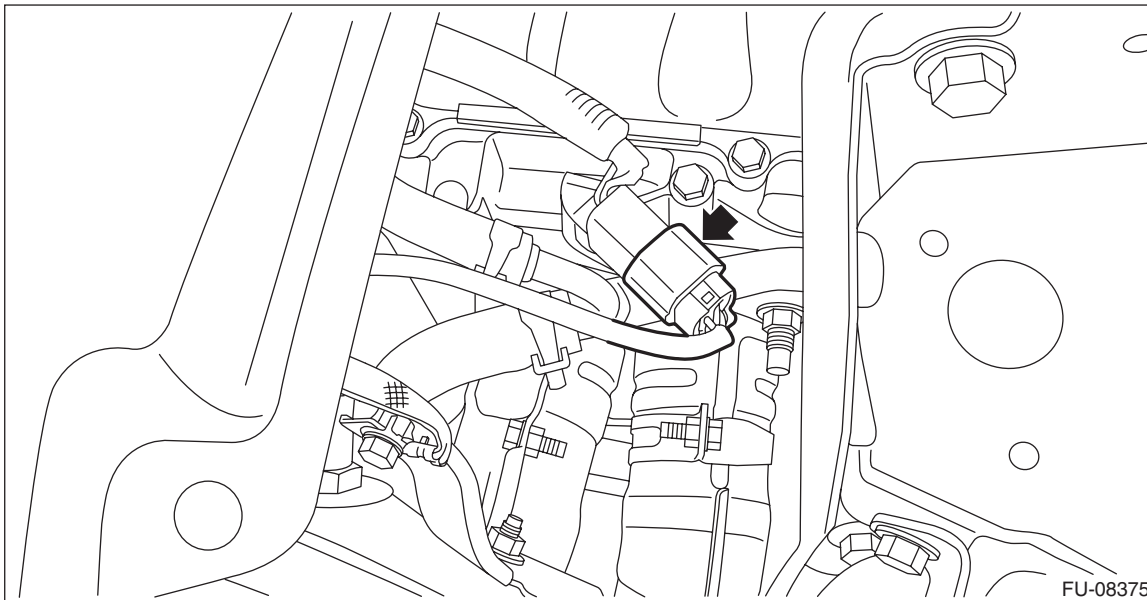

- 5) Apply spray-type lubricant to the threaded portion of rear oxygen sensor, and leave it for one minute or more.
- 6) Remove the rear oxygen sensor.

#### CAUTION:

**When removing the rear oxygen sensor, wait until exhaust pipe cools, otherwise it will damage the exhaust pipe.**

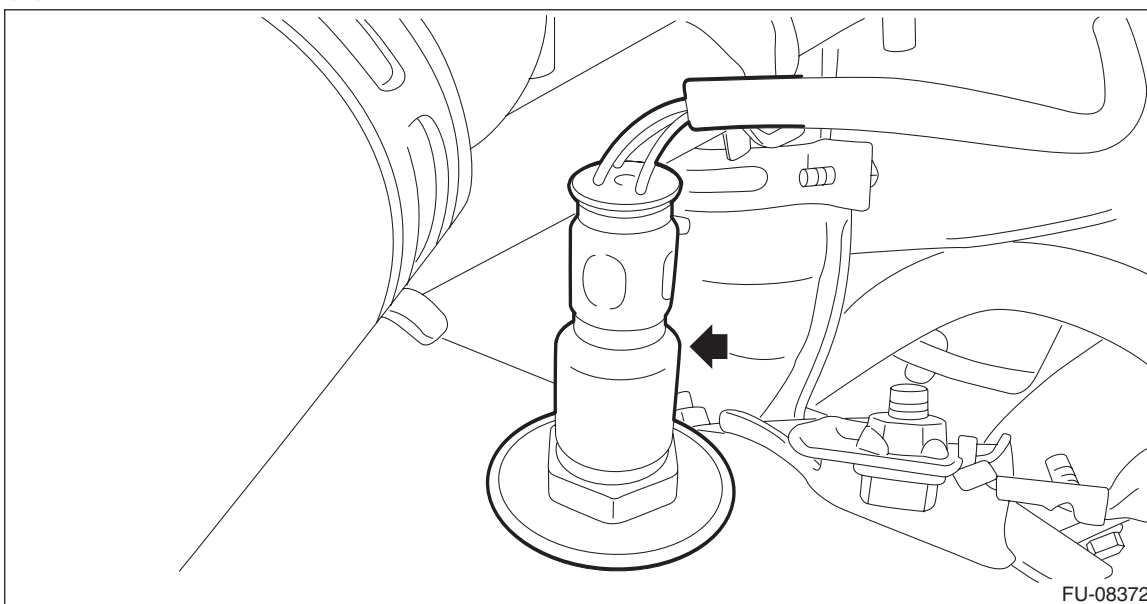

## B: INSTALLATION

### CAUTION:

If lubricant is spilt over the exhaust pipe, wipe it off with cloth to avoid emission of smoke or causing a fire.

1) Before installing rear oxygen sensor, apply the anti-seize compound only to the threaded portion of rear oxygen sensor to make the next removal easier.

### CAUTION:

Never apply anti-seize compound to the protector of rear oxygen sensor.

### Anti-seize compound:

**NEVER-SEEZ NSN, JET LUBE SS-30 or equivalent**

2) Install the rear oxygen sensor.

### Tightening torque:

**21 N·m (2.1 kgf-m, 15.5 ft-lb)**

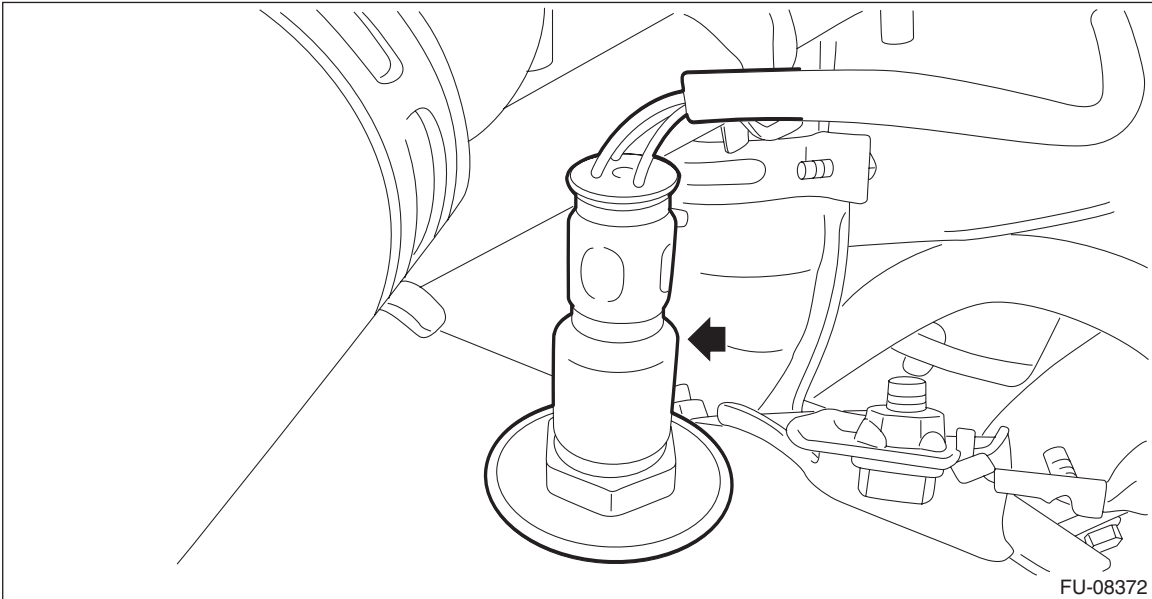

FU-08372

3) Connect the rear oxygen sensor connector to the engine harness.

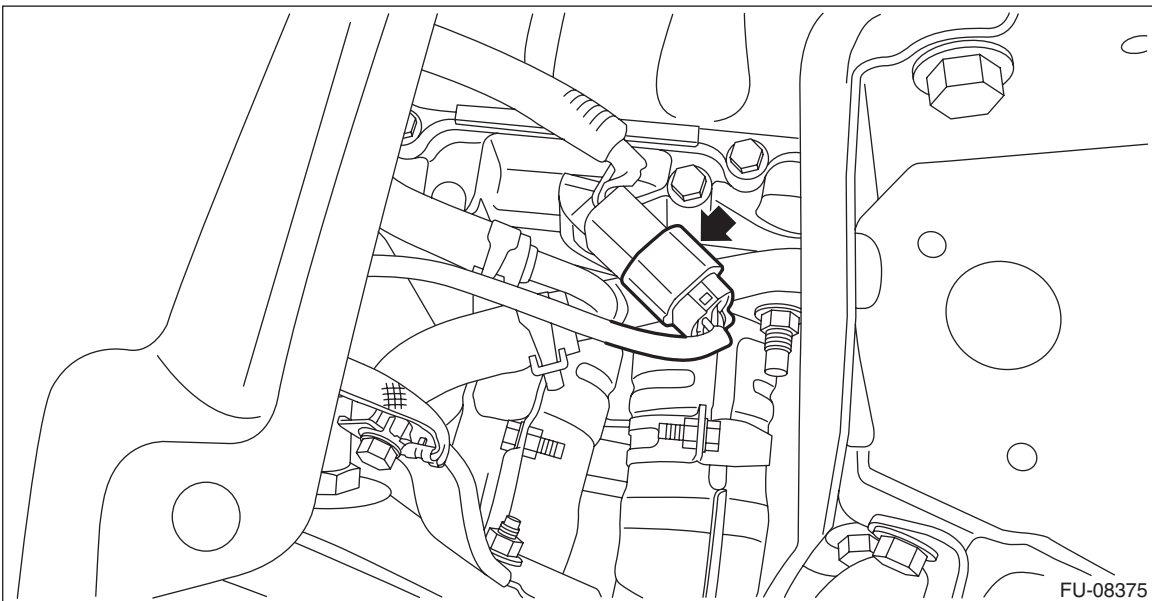

FU-08375

4) Install the under cover. <Ref. to EI-22, INSTALLATION, Front Under Cover.>

5) Lower the vehicle.

6) Connect the ground terminal to battery sensor. <Ref. to NT-5, BATTERY, NOTE, Note.>

## Rear Oxygen Sensor

FUEL INJECTION (FUEL SYSTEMS)

### C: INSPECTION

- 1) Check that the rear oxygen sensor has no deformation, cracks or other damages.
- 2) Measure the resistance between rear oxygen sensor terminals.

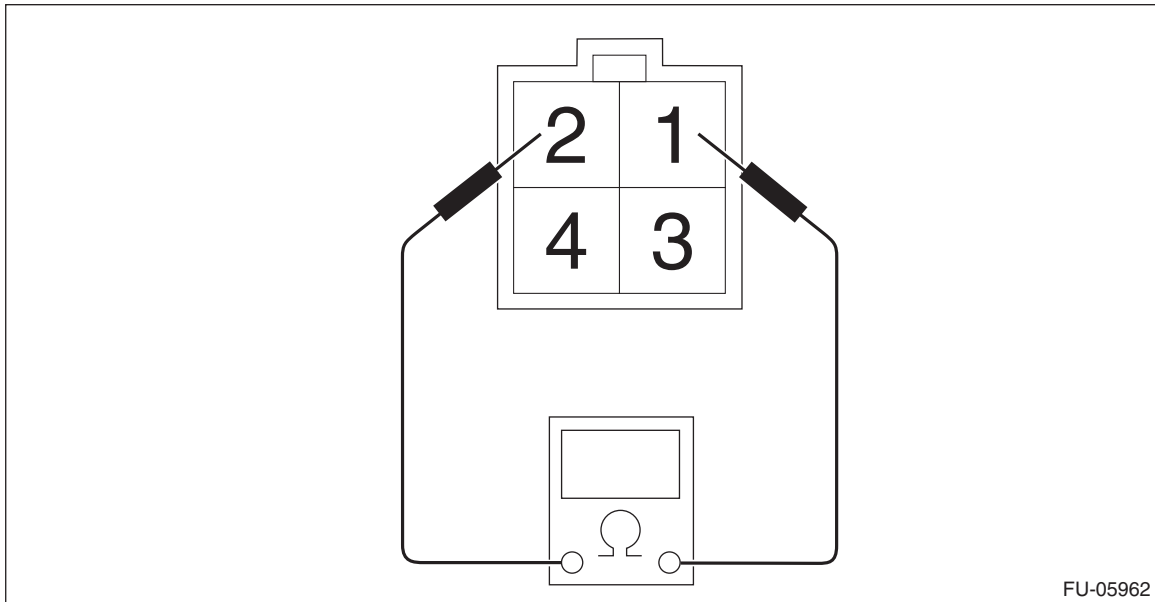

Terminal No.	Standard
1 and 2	$13.0^{+1.5}_{-1.3} \Omega$ (when 20°C (68°F))